

ABERNATHY and ASSOCIATES

Kenneth B. Abernathy Jr.

Wisconsin Registered Land Surveyor S-1594

Rt. 3, Box 273
Elkhorn, Wisconsin 53121
Phone: (414) 723-4260 (office)
(414) 723-4813 (residence)

PLAT OF SURVEY

Pleasant Lake Road

LEGAL DESCRIPTION

Lot 24 of Dunbar Estates Subdivision,
Located in the North 1/2 of the Southeast
1/4 of Section 36, Town 4 North, Range 16
East, Town of La Grange, County of
Walworth, State of Wisconsin.

66' Wide

N 89°41'05" E 265.00'

Common Driveway Easement
20' Wide

Existing Residence
(Under Construction)

Lot 23

Lot 24
1.77 Acres ±

Lot 25

Ordered by: Neumann Developments
Suite 206
4450 Milton Avenue
Janesville, WI. 53546

Owner: Stier

Legend

- FOUND IRON PIPE
- FOUND IRON ROD
- FOUND BRASS CAPPED MONUMENT
- FOUND CONCRETE MONUMENT
- + CHISEL CUT IN CONCRETE
- SET IRON ROD, 24" LONG, WEIGHING 1.5 LBS., LINEAL FT., 3/4" DIA.
- SET IRON ROD, 30" LONG, WEIGHING 4.5 LBS., LINEAL FT., 1-11/16" DIA.
- (xx) RECORDED AS DIMENSION
- x-x- EXISTING FENCE

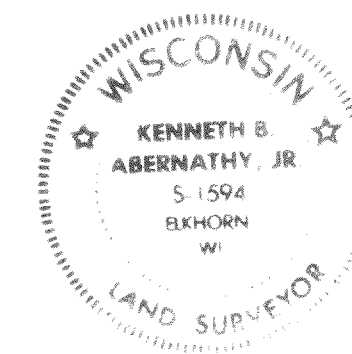

SCALE: 1" = 30 FEET

"I hereby certify that I have surveyed the above described property and that the above map is a true representation thereof and shows the size and location of the property, its exterior boundaries, the location of all visible structures and dimensions of all principal buildings thereon, boundary fences, apparent easements, roadways and visible encroachments, if any."

"This survey is made for the use of the present owners of the property, and also those who purchase, mortgage, or guarantee the title thereto within one year from date hereof."

Kenneth B. Abernathy Jr.

KENNETH B. ABERNATHY, JR.
WISCONSIN REGISTERED LAND SURVEYOR,
S-1594

Date: May 14, 1992 Job No. 1992-107